

CXB-92 series *Heavy-duty*

Incremental Encoder

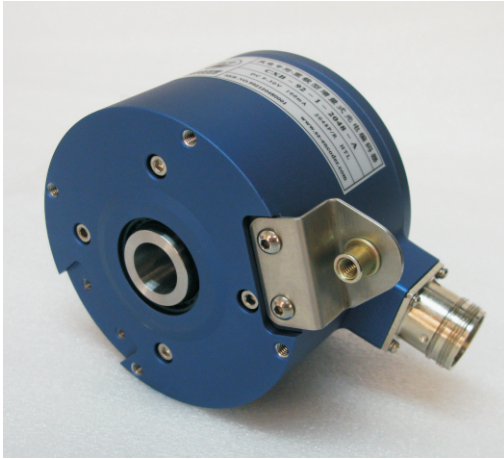

Special features :

- ▶ Special rugged housing for high vibration and shock resistance
- ▶ HeavyDuty design for high shaft load
- ▶ Hollow shaft up to $\phi 20$ mm or $\phi 17$ mm cone 1:10
- ▶ Advanced high-reliability optical reading system, good performance in electromagnetic compatibility
- ▶ Overvoltage, overcurrent, surge protection.
- ▶ HTL or TTL
- ▶ 9-30VDC, Single power supply, polarity protection
- ▶ Electrically insulated up to 2.5 Kv
- ▶ IP 66
- ▶ 2 years warranty

Product application:

- ▶ Applicable for displacement and velocity measurement of Wind power generator and other heavy equipments under extremely harsh environment

Output Circuit

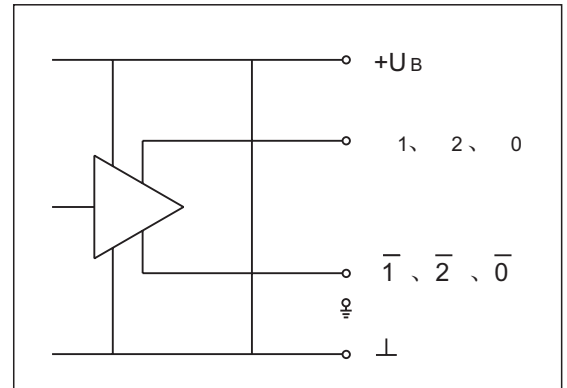

Output Signals

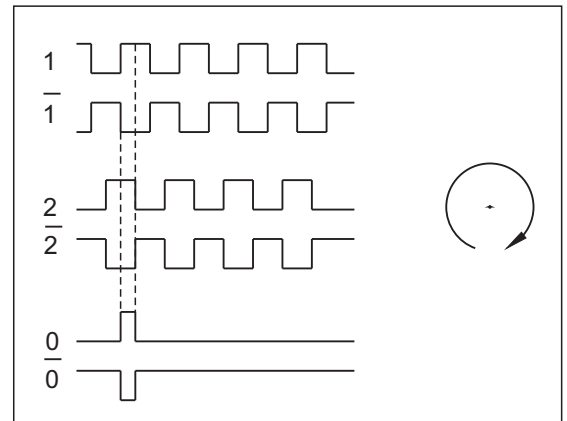

Connection

Wiring terminal	EV	0V	0	$\bar{0}$	1	$\bar{1}$	2	$\bar{2}$	SHLD
	EV	0V	0	$\bar{0}$	1	$\bar{1}$	2	$\bar{2}$	
12Pin	12	10	3	4	8	1	5	6	Body
Colour	RED	BLK	GRA	WHT	BLU	GRN	BRN	YEL	

Electrical Specification

Cycles per turn	500 512 600 1000 1024 2000 2048 2500 3072 3600
Out frequency	120KHz
Rise time	$\leq 10V/\mu s$
Supply voltage UB	+9V ~ +30V
Current consumption at no-load	$\approx 100mA$
Out voltage ($U_B=24V$)	$U_L \leq 1.5V$; $U_H \geq U_B - 3.5V$
Maximum load current per channel	60mA/average; 200mA/peak
Mark space ratio	1:1 $\pm 20\%$
Square wave displacement	$90^\circ \pm 20\%$

Mechanical Specification

Hollow shaft diameter	$\phi 16mm / \phi 12mm$ Stainless steel
Moment of inertia	$\approx 550gcm^2$
Speed max	$\leq 4000r/min$
Maximum shaft load	Axial 100N; Radial 300N
Vibration resistance	$\leq 10G/55\sim 2000Hz$
Shock resistance	$\leq 100G/11ms$
Permissible encoder temperature	$-40^\circ C \sim +85^\circ C$
Protection class	IP66
Weight	$\approx 1.30Kg$

■ **Dimensions**

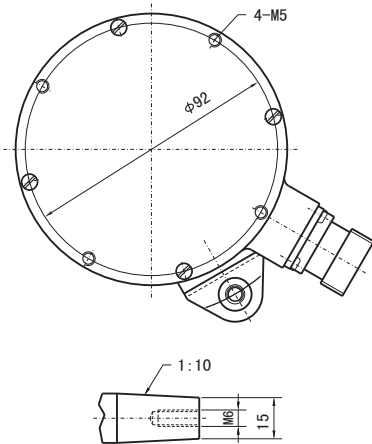

Recommended mating shaft

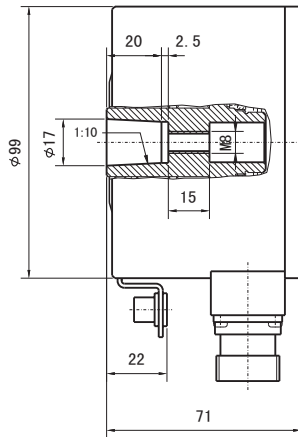

Cone hole, 12 pin EML, 30° Torque arm

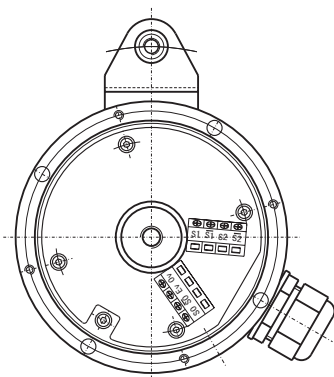
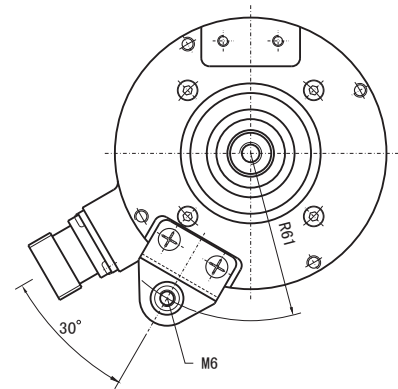

Removal of tail cover

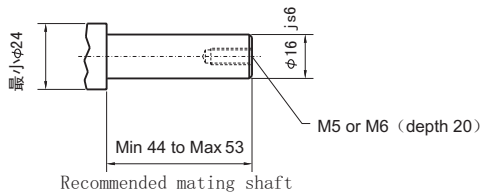

Recommended mating shaft

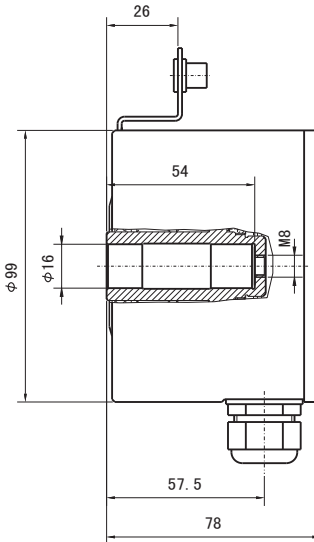

Straight hole, M20 cable gland, 120° Torque arm

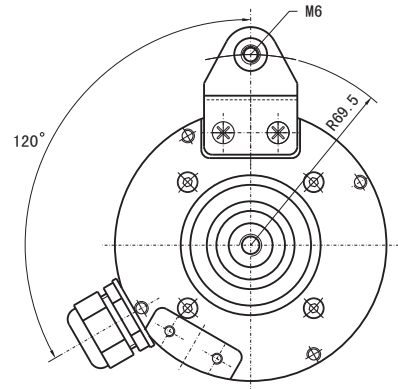

■ **Ordering Information**

CXB — **92 B** — **1** — **2048** — **A** — **B**

Manufacturer: CXB

Type: 92 Series Heavy-duty Incremental

Not specified: 12 pin EML B: M20 cable gland

Codewheel materials: 1. Glass; 2. Plastic; 3. Metal

Not specified: Cone hole
B: Straight hole

A: 30° Torque arm
B: 120° Torque arm

Cycles per turn: 500 512 600 1000 1024
2000 2048 2500 3072 3600
(Other needs contact with the manufacturer)

Remarks: 1. Technical modifications reserved.

2. The default 12 pin EML clockwise, If there are anti-clockwise demand, please in ordering.

■ **Guarantee**

2 years warranty within the conditions of Normal use and maintenance.



深圳市英科達光電技術有限公司

Shenzhen ENCODER Optics-Electronics Technology Co., Ltd

Tel: +86-0755-26683042; Fax: +86-0755-26686503

E-mail: support@sz-encoder.com

WWW.SZ-ENCODER.COM